

SARS-CoV-2 & Influenza A/B Combo Rapid Test Kit

新冠及流感合一快速測試套



新冠測試表現

靈敏度:>99%

特異性:>99%

準確度:>99%

流感測試表現(綜合)

靈敏度:>91%

特異性:>96%

準確度:>93%

符合歐盟CE規定

15分鐘有結果!

產品包裝正面照片

SARS-CoV-2 & Influenza A/B Antigen Combo Rapid
Test Kit (Lateral Chromatography)



Contents:

Test Cassette*1;

Disposable Swab*1;

Sample Extraction Solution*1

Biohazard Disposal Bag*1; Instruction for Use*1

Attention:

1. Do not touch the reaction area of test cassette.

2. Do not use expired test kit.

3. Disposal: All specimen and the used kit have the infectious risk. The used test cassette should be discarded according to federal, state and local regulations.

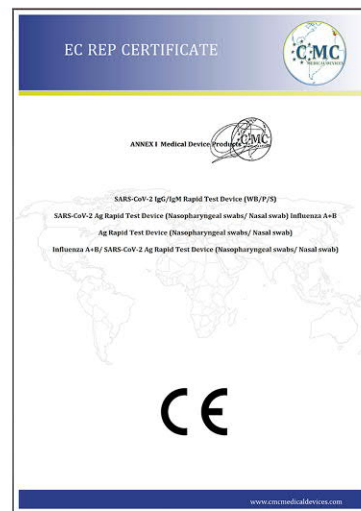

盒裝背面

採樣本方法1: 採鼻腔樣本



新冠流感2合1快速測試

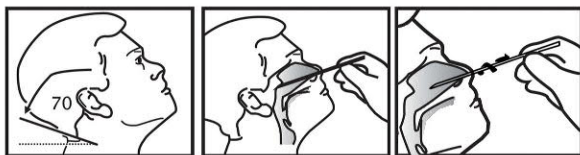

或

採樣本方法2: 咽喉取樣本



測試程序:
(取樣本後)

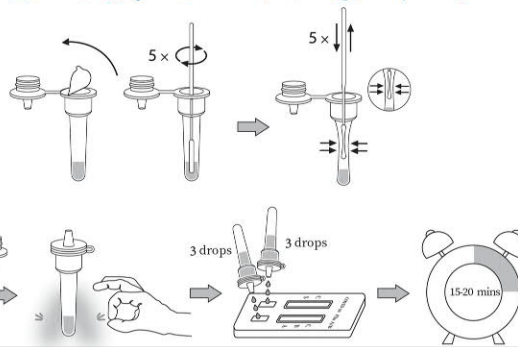

新型冠狀病毒測試結果 結果分析

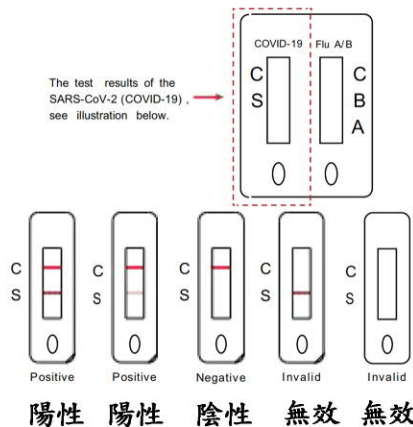

甲乙型流感測試結果

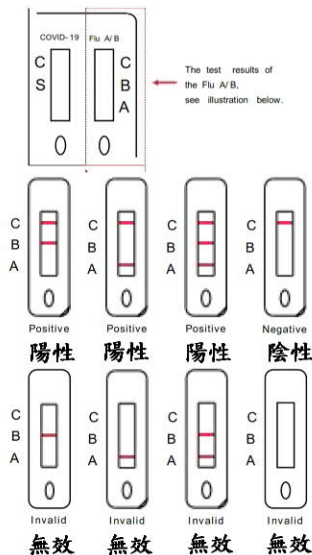

每盒檢測包含以下組件：



數據只供參考，
診斷結果以醫生判斷為準。